

Kinex Fix2Lock

Peek Lateral

I FEATURES

- ☀ Self-PUNCHING tip for ease of USE
- ☀ DOUBLE helix screw thread to enhance fixation strength
- ☀ FULLY CANNULATED design for efficient bone growth



OSTEONIC
The Medical Explorer



LASTINGLIFE
MEDICAL

Kinex Fix2Lock

Peek Lateral

SUTURE passing: Up to 4 SUTURES or 3tapes

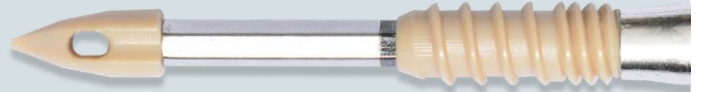

Kinex Fix2Lock Peek Lateral anchor is made of RADIOLUCENT PEEK material which is revisable and biocompatible with the similar MODULUS of cortical bone. It provides SUPERIOR torsional and PULLOUT strength for rotator CUFF repair. The design of the self-PUNCHING tip enables physicians with no need to USE the INSTRUMENT DURING insertion PROCEDURE.

Ordering Information

I Peek Solid Type

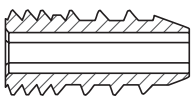

Size	Item Code	SUTURE Color
Ø4.5	PLA-4521-1030	White/Green <input checked="" type="checkbox"/>
	PLA-4521-1910	White 2 <input type="checkbox"/>
Ø5.5	PLA-5521-1030	White/Green <input checked="" type="checkbox"/>
	PLA-5521-1910	White 2 <input type="checkbox"/>

I Peek Healmax Type

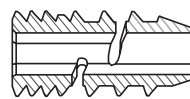

Size	Item Code	SUTURE Color
Ø4.5	PLA-4521-1030	White/Green <input checked="" type="checkbox"/>
	PHL-4521-1910	White 2 <input type="checkbox"/>
Ø5.5	PLA-5521-1030	White/Green <input checked="" type="checkbox"/>
	PHL-5521-1910	White 2 <input type="checkbox"/>

INSTRUMENT Image	Item Code	Description
	BLA-4750-Punch-1	Reusable Punch

Diameter

Size	A	B
Ø4.5	4.5	12.0
Ø5.5	5.5	12.0

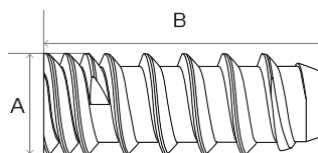

PULLOUT Strength

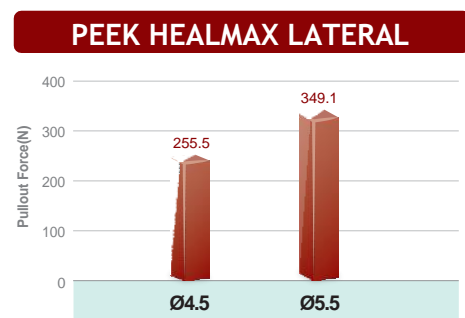
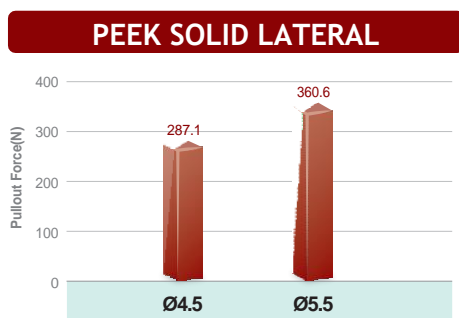

• Note: Test was CONDUCTED in 15PCF bone block

• Data: Osteonic lab.

OSTEONIC Co., Ltd.

1206ho, 38, Digital-ro 29-gil, Guro-gu, Seoul, Korea

Tel. +82 26902 8400 Fax. +82 26902 8401 www.osteonic.com